

Keylar Work Bench

Keylar work bench is a hand loaded and unloaded system. Whilst mechanical devices maybe useful for gaining access to higher storage levels, the placement of products is a manual process.

This product requires some assembly

Product Dimensions

Bay Height:	900mm
Beam Length:	1285mm
Bay Depth:	410mm
Shelf Weight Loadings:	Depends on the length of beam
Indicative Weights:	1285mm - 420 kg U.D.L.

U.D.L. Uniformly distributed load = the shelf, beam and bay capacities vary depend on the beam length. Indicative weights are as shown above and based on your shelving configuration. Please contact the Keylar Team should you require an alternative colour or size or steel shelves.

Colour – Black
Indoor Use Only

A. Components

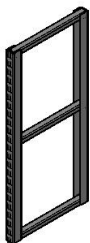
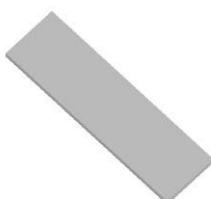

Fig 1. End Frame

2pcs x End Frame
4pcs x Bench Beams
2pcs x Boards



Bench Beams



Board

B. Assembly Instructions

Equipment – rubber mallet

The bench support beam, simply clips into the top of the end frames to support the timber or 1.6mm thick steel shelf. The under shelf level is fully adjustable along the height, simply clip into the end frames to support a 16mm timber or 1.6mm thick steel shelf.

1. Stand the end frames and clip in one beam at a time starting at the base level of the end frames.
2. Clip in the bench beams

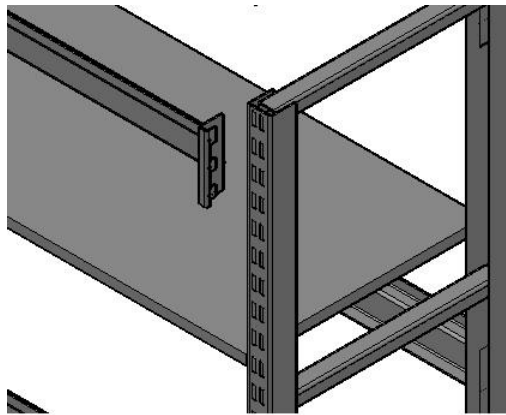

3. Lay the boards directly on top of the beams.

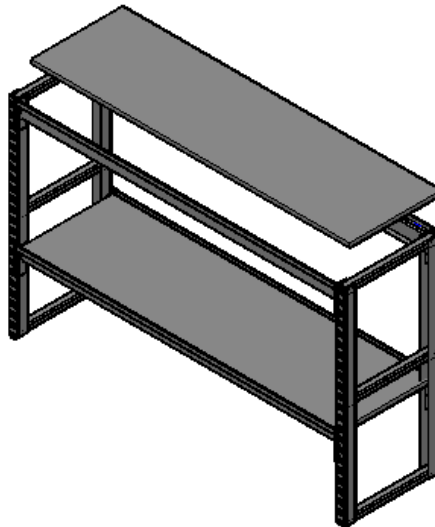

4. If using steel shelves lay the steel shelf over the top of the beams.

Care Instructions

Wipe clean with a mild soapy solution.
Wipe dry with a clean cloth.