

Wall Strip Shelving – Laundry Option

This product requires some assembly

Wall Strip Shelving is an economical way of providing wall mounted shelving for any light duty application and is for indoor use only.

There are four options for Wall Strip Shelving namely: (1) Cupboard; (2) Office; (3) Garage and (4) Laundry options. This document describes the Laundry option in detail



Product Dimensions:

- Wall Strips: 3 x Single Slot - 1.6mm steel
- Slot Pitch: 40mm
- Lengths: 900mm
- Brackets: 2.0mm steel folded (Timber Shelves)
- To Suit Board Depth: 300mm

Weight Loading (guide only): 90kg U.D.L. over 1 metre providing wall strips are attached to the wall securely and at 600mm centres. Load capacity will also depend on the wall construction and composition.

The weight loading of the shelf will depend on the type of fixings used and the nature of the wall to which the wall stripping is fixed. The weakest point will not be the shelf, brackets or wall strip, but how the wall stripping is attached to the wall. The weight carrying capacity of the shelf will decrease as the depth of the shelf increases and the number of shelf levels on the stripping. Shelves deeper than 500mm are generally not suitable for wall strip shelving.

U.D.L. Uniformly distributed load = the shelf, beam and bay capacities vary depend on the beam length. Indicative weights are as shown above and based on your shelving configuration.

Key Features

Shelf levels are fully adjustable along the height of the wall strip.

Counter sunk holes in wall strips for attachment to wall.

Using Keylar's folded bracket to hold the timber shelf, the timber shelf sits on the top fold of the bracket and is screwed from underneath through the pre-drilled bracket and into the timber. This is the only secure way for fixing a timber shelf to a wall bracket.

16mm white moisture resistant melamine timber shelves edged all round or powder coated steel shelves are available.

Standard colour - Bright White

Timber Shelves

16mm White Moisture Resistant Melamine

Steel Shelves

Telephone for a quote.

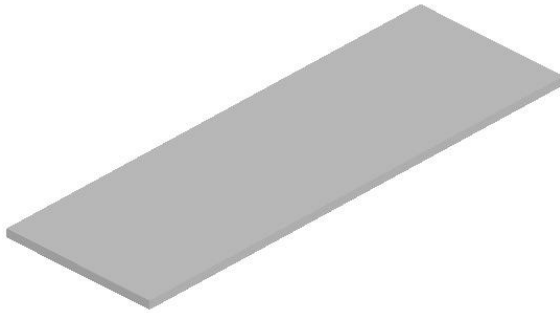
Components

Figure 1 Timber shelf x 3, contact Keylar for Steel shelves

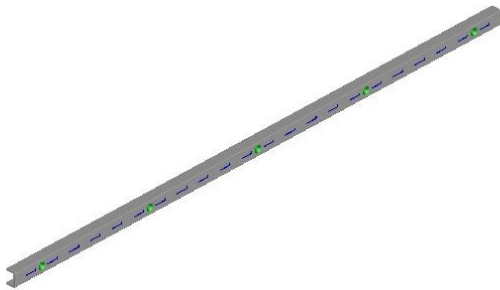


Figure 2 Wall strips x 3

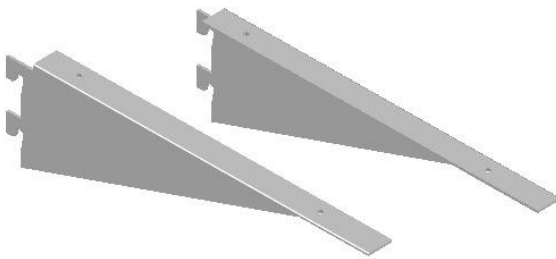
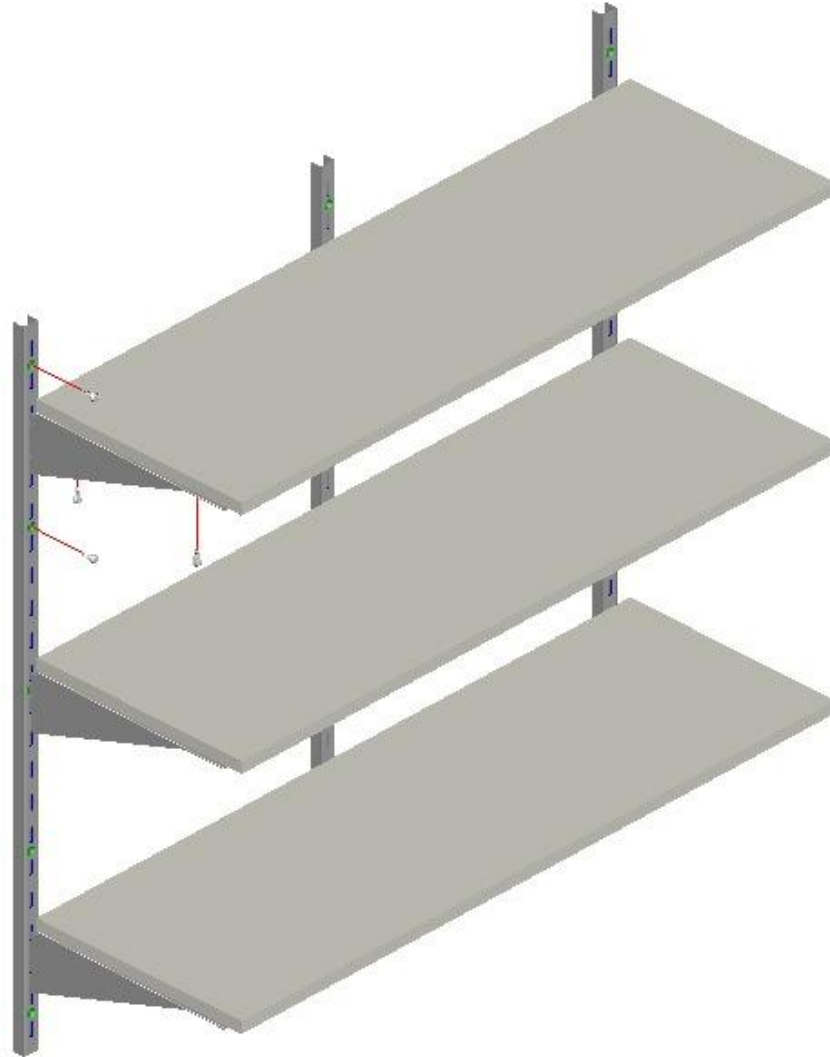


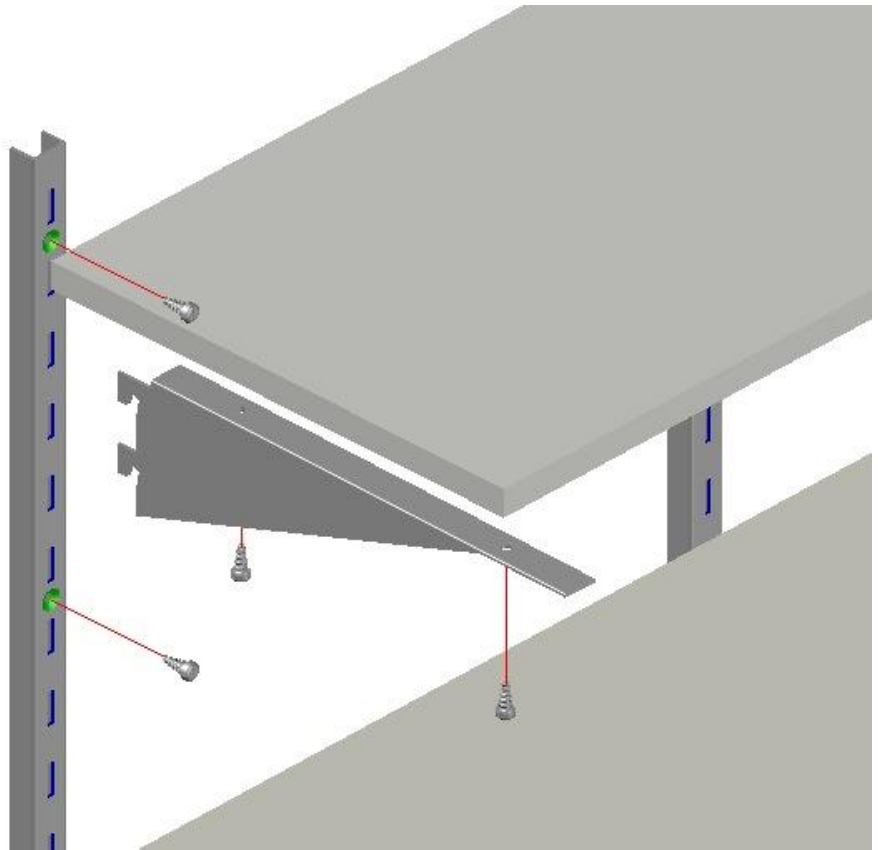
Figure 3 Brackets x 9



Figure 4 Screws

Assembly Instructions**1. Secure Fixing to the Walls**

The vertical wall stripping should be screw-fixed to rigid solid walls or wall studs. The wall strips should not be fixed to the plaster sheeting of plaster walls using wall mates or similar devices - fix to the timber or steel studs that support the plaster sheets. The Wall Stripping has 5mm fixing holes every 250mm. The Wall Stripping should be screw fixed through every hole to maximise the weight carrying capacity of the shelving.



2.Ensure that the Wall Stripping is installed to a level horizontal line

Use a laser level, large spirit level or water-filled tubing to make sure the wall stripping is installed level. Many floors are undulating or sloping. Installing the wall stripping off floor level may result in an unlevelled installation with sloping or undulating shelves.

3.Fixings

For most applications screws 40mm or longer are used. 8 gauge, self tapping, zinc plated, Phillips slot (or Pozidrive), dome head screws are typically used for steel framing or hard timber studs. More aggressive wood screws are recommended for softer timber studs like pine. Plastic plugs and compatible screws are recommended for most brick or concrete walls. Special fixings may be required for soft sandstone or brick walls - ask your hardware store or specialist fastenings supplier for advice.

4.Horizontal Spacings

We recommend that wall stripping supporting timber shelves should be attached at 600mm centres wherever possible. Timber studs in older buildings are typically 450mm apart, while steel and timber framing in more modern buildings is often 600mm apart. Use a Stud Finder to locate the position of the studs. The horizontal spacing of the wall stripping installed on concrete or brick walls is often determined by aesthetics with the wall strips installed with equal spacing to fill the wall length exactly, but every effort should be taken to achieve 600mm centres for the wall strips. Heavy applications may require the Wall Stripping to be installed every 450mm. Wall stripping supporting steel shelves can be attached up to 1200mm centres but the weight loading of the 1200mm long or smaller shelf must be no more than 50 kg U.D.L. and will depend on the wall construction and composition.



Weight Loading

The weight loading of the shelf will depend on the type of fixings used and the nature of the wall to which the wall stripping is fixed. The weakest point will not be the shelf, brackets or wall strip, but how the wall stripping is attached to the wall. The weight carrying capacity of the shelf will decrease as the depth of the shelf increases and the number of shelf levels on the stripping. Shelves deeper than 500mm are generally not suitable for wall strip shelving.

Good to Know

- Different wall materials require different types of fixing devices. Use fixing devices suitable for the walls in your home are sold separately at your local hardware.
- Different wall materials support different loads of weight, for instance, a wall made of plaster cannot support as much weight as walls made of wood, concrete or brick.
- If you are uncertain about what type of fixing devices to use, please contact your local hardware store.
- Only for indoor use.
- Powder coated (45-50 microns thickness) steel
- Standard colour: Bright White

Care Instructions

- Wipe clean with a mild soapy solution.
- Wipe dry with a clean cloth.

Our Planet

The steel in this product may be recyclable. Please check the recycling rule in your community for recycling facilities.